

Output Coordinate System

WGS_1984_UTM_Zone_18N (EGM96 Geoid)

Processing Options

Detected Template	3D Mapping
Keypoints Image Scale	Full, Image Scale: 1
Advanced: Matching Image Pairs	Free Flight or Terrestrial
Advanced: Matching Strategy	Use Geometrically Verified Matching: no
Advanced: Keypoint Extraction	Targeted Number of Keypoints: Automatic
Advanced: Calibration	Calibration Method: Standard Internal Parameters Optimization: All External Parameters Optimization: All Rematch: Auto, yes

Point Cloud Densification details**Processing Options**

Image Scale	multiscale, 1/8 (Eighth image size, Tolerant)
Point Density	Optimal
Minimum Number of Matches	3
3D Textured Mesh Generation	yes
3D Textured Mesh Settings:	Resolution: High Resolution Color Balancing: yes
LOD	Generated: yes
Advanced: 3D Textured Mesh Settings	Sample Density Divider: 1
Advanced: Image Groups	group1
Advanced: Use Processing Area	yes
Advanced: Use Annotations	yes
Time for Point Cloud Densification	01m:47s
Time for Point Cloud Classification	06s
Time for 3D Textured Mesh Generation	11m:08s

Results

Number of Generated Tiles	1
Number of 3D Densified Points	378919
Average Density (per m ³)	1.95

DSM, Orthomosaic and Index Details**Processing Options**

DSM and Orthomosaic Resolution	1 x GSD (5.75 [cm/pixel])
DSM Filters	Noise Filtering: yes Surface Smoothing: yes, Type: Sharp
Raster DSM	Generated: yes Method: Inverse Distance Weighting Merge Tiles: yes
Orthomosaic	Generated: yes Merge Tiles: yes
Raster DTM	Generated: yes Merge Tiles: yes
DTM Resolution	5 x GSD (5.75 [cm/pixel])
Time for DSM Generation	02m:03s
Time for Orthomosaic Generation	06m:54s
Time for DTM Generation	01m:35s
Time for Contour Lines Generation	00s
Time for Reflectance Map Generation	00s

Geolocation Details

Absolute Geolocation Variance

Min Error [m]	Max Error [m]	Geolocation Error X[%]	Geolocation Error Y[%]	Geolocation Error Z[%]
-	-15.00	0.00	0.00	12.05
-15.00	-12.00	0.00	0.00	8.43
-12.00	-9.00	0.00	0.00	0.00
-9.00	-6.00	0.00	0.00	0.00
-6.00	-3.00	0.00	0.00	2.41
-3.00	0.00	54.22	60.24	13.25
0.00	3.00	45.78	38.55	6.02
3.00	6.00	0.00	1.20	33.73
6.00	9.00	0.00	0.00	24.10
9.00	12.00	0.00	0.00	0.00
12.00	15.00	0.00	0.00	0.00
15.00	-	0.00	0.00	0.00
Mean [m]		0.001456	0.001803	-0.000540
Sigma [m]		0.801328	0.617765	8.299170
RMS Error [m]		0.801329	0.617767	8.299170

Min Error and Max Error represent geolocation error intervals between -1.5 and 1.5 times the maximum accuracy of all the images. Columns X, Y, Z show the percentage of images with geolocation errors within the predefined error intervals. The geolocation error is the difference between the initial and computed image positions. Note that the image geolocation errors do not correspond to the accuracy of the observed 3D points.

Relative Geolocation Variance

Relative Geolocation Error	Images X[%]	Images Y[%]	Images Z[%]
[-1.00, 1.00]	100.00	100.00	79.52
[-2.00, 2.00]	100.00	100.00	100.00
[-3.00, 3.00]	100.00	100.00	100.00
Mean of Geolocation Accuracy [m]	5.000000	5.000000	10.000000
Sigma of Geolocation Accuracy [m]	0.000000	0.000000	0.000000

Images X, Y, Z represent the percentage of images with a relative geolocation error in X, Y, Z.

Geolocation Orientational Variance	RMS [degree]
Omega	0.613
Phi	1.936
Kappa	1.455

Geolocation RMS error of the orientation angles given by the difference between the initial and computed image orientation angles.

Initial Processing Details

System Information

Hardware	CPU: Intel(R) Core(TM) i7-8750H CPU @2.20GHz RAM: 24GB GPU: Intel(R) UHD Graphics 630 (Driver: 27.20.100.8935), NMDIA GeForce GTX 1050 Ti (Driver: 27.21.14.6231)
Operating System	Windows 10 Pro, 64-bit

Coordinate Systems

Image Coordinate System	GCS_WGS_1984 (EGM96 Geoid)
-------------------------	----------------------------

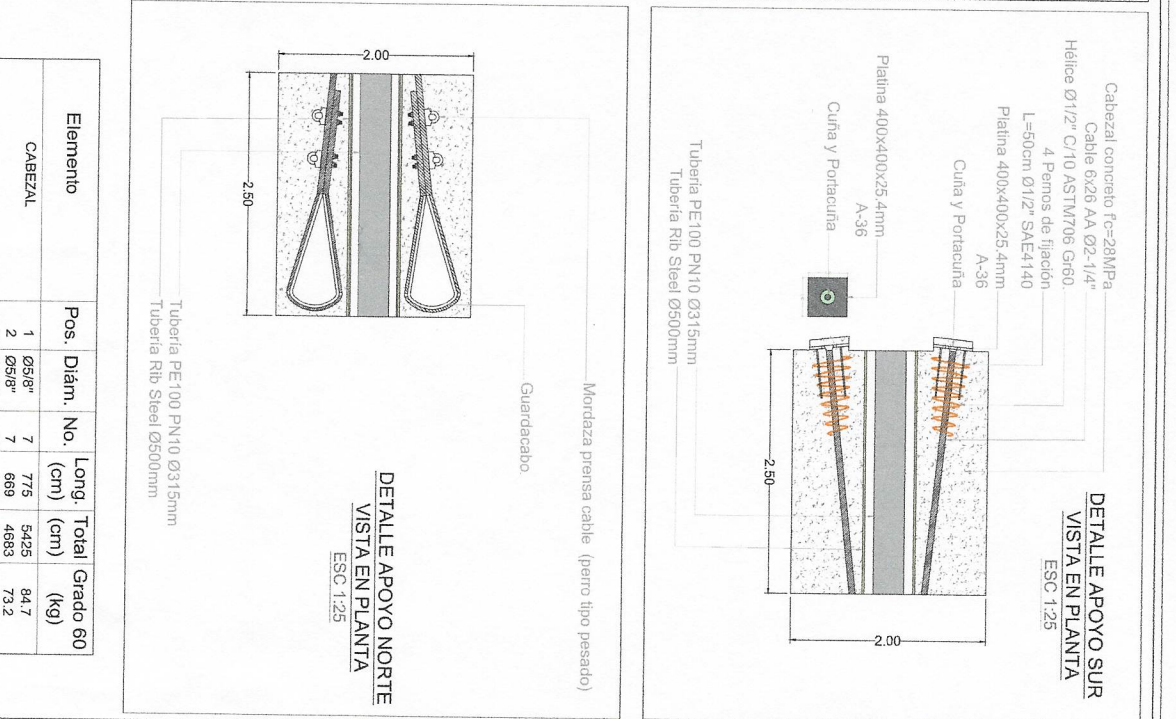
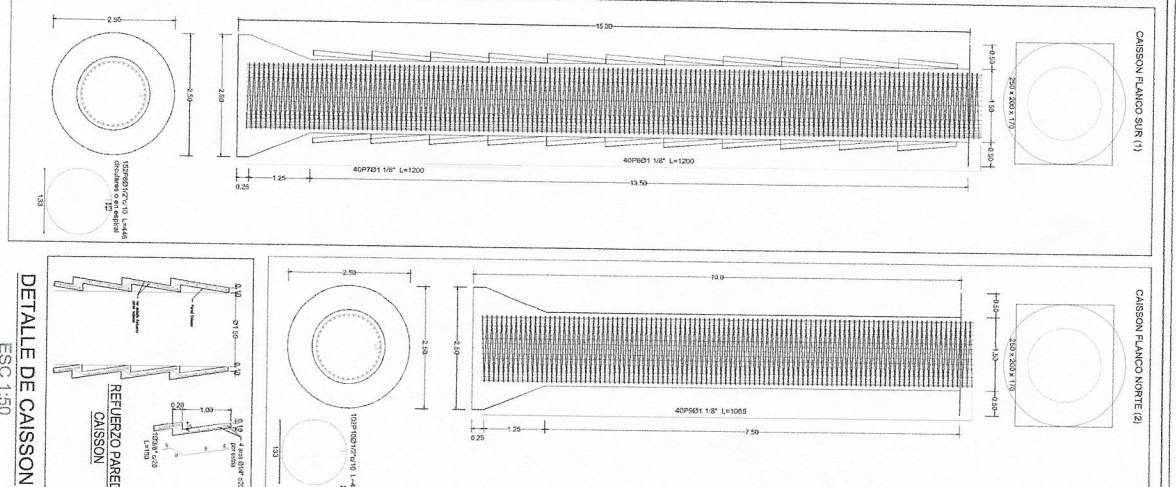
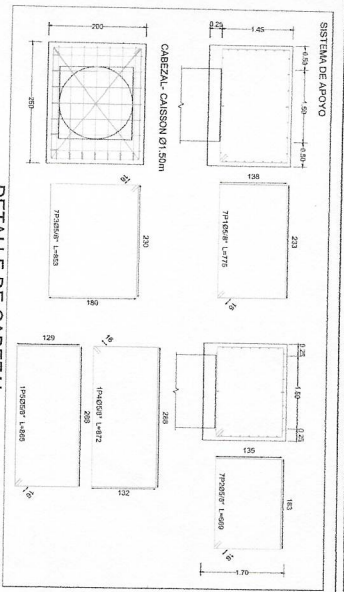

NOTAS Y ESPECIFICACIONES

Primarily the contractor shall be responsible for the design and construction of the support structure (including the reinforcement and the concrete) and the contractor shall be responsible for the design and construction of the support structure (including the reinforcement and the concrete).

The contractor shall be responsible for the design and construction of the support structure (including the reinforcement and the concrete) and the contractor shall be responsible for the design and construction of the support structure (including the reinforcement and the concrete).

The contractor shall be responsible for the design and construction of the support structure (including the reinforcement and the concrete) and the contractor shall be responsible for the design and construction of the support structure (including the reinforcement and the concrete).

ITEM	DESCRIPCIÓN	CANTIDAD	UNIDAD	VALOR UNITARIO	VALOR TOTAL
1	CAISSON FLANCO SUR (1)	1	m ²	42800	42800
2	CAISSON FLANCO NORTE (2)	1	m ²	42800	42800
3	DETALLE APOYO SUR VISTA EN PLANTA	1	m ²	2144.6	2144.6
4	DETALLE APOYO SUR VISTA EN PLANTA	1	m ²	450.4	450.4
5	TUBERÍA PE-100 PN10 Ø315mm	10	m	42492	42492
6	TUBERÍA RIB STAINLESS STEEL Ø500mm	10	m	2595.0	2595.0
7	TUBERÍA PE-100 PN10 Ø315mm	10	m	42492	42492
8	TUBERÍA RIB STAINLESS STEEL Ø500mm	10	m	2595.0	2595.0
9	TUBERÍA PE-100 PN10 Ø315mm	10	m	42492	42492
10	TUBERÍA RIB STAINLESS STEEL Ø500mm	10	m	2595.0	2595.0

Elemento	Pos.	Diam.	No.	Long. (cm)	Total (cm)	Grado 60 (kg)
CABEZAL	1	Ø5/8"	7	775	5425	84.7
	2	Ø5/8"	7	669	4683	73.2
	3	Ø5/8"	7	853	5971	89.3
	4	Ø5/8"	1	872	872	13.6
	5	Ø5/8"	1	865	865	13.5
CAISSON FLANCO SUR	6	Ø1 1/8"	40	1200	48000	2416.4
	7	Ø1 1/8"	40	600	24000	1208.2
	8	Ø1/2"	192	446	67792	671.2
CAISSON FLANCO NORTE	9	Ø1 1/8"	40	1065	42600	2144.6
	10	Ø1/2"	192	446	42492	450.4
	Total:					2595.0

empocaldes - Centro Nacional de Estudios y Asesoría

INGENIERIA - INGENIERIA CIVIL

PROYECTO - VANDERSON CANTU - ASERVA - OBRAS DE RECONSTRUCCION DEL CENTRO DE ESTUDIOS Y ASERVA

CLIENTE - MINISTERIO DE EDUCACION - M.E.

FECHA - 15/03/2013

PROYECTO - VANDERSON CANTU - ASERVA - OBRAS DE RECONSTRUCCION DEL CENTRO DE ESTUDIOS Y ASERVA

CLIENTE - MINISTERIO DE EDUCACION - M.E.

FECHA - 15/03/2013

PROYECTO - VANDERSON CANTU - ASERVA - OBRAS DE RECONSTRUCCION DEL CENTRO DE ESTUDIOS Y ASERVA

CLIENTE - MINISTERIO DE EDUCACION - M.E.

FECHA - 15/03/2013

